

" TECHNICAL DETAILS "

- Build in : 2022
- LOA : 14,54m
- Beam : 7,66 m
- Draft : 1,22 m
- Engine : YANMAR 2x57 HP
- F.Water Capacity : 800 L
- Diesel Capacity : 800 L
- Cabins : 4
- Berths : 8 + 2 +1

BASE & GOCEK & CLIMATE

- ★ Reliable base with high customer satisfaction
- ★ Fully equipped boats in excellent condition
- ★ 7/24 technical assistance and support
- ★ Perfect starting point for a cruise
- ★ Just 20 min. away from Dalaman Airport
- ★ Fair and constant winds for sailing
- ★ About 300 sunny days a year

Special Equipment:

Classical Main sail	80,3 m ²	Bowthruster	- - -	Chartplotter in Cockpit	✓
Furling Genoa sail	44,0 m ²	Solar Panel	✓	1 Steering wheel	✓
Spiboom	- - -	Sprayhood	- - -	Cockpit Loudspeaker	✓
Asym Spinnaker extra price	- - -	Inverter (220V/12 V – 2000W)	✓	WC - Shower	4+1

Extras: Watermaker 200 l/h, Electrical main sail and genoa sail winch, Fly Bridge, Open Saloon , Cockpit Chain Counter, Generator / AirConditioner in saloon and cabins, Cabin Fans, Dish Washing machine, Grill, Electrical David, Skipper Cabin & WC, Walk through to front deck, Hidrolic lifting platform in saloon, Self Tacking Genoa, Sunbath Mats in front deck and flybridge,Electrical WC pump.

NAVIGATION & ELECTR. :

- ✓ GPS with Chartplotter
- ✓ Nav.Charts
- ✓ Nav. aids
- ✓ Nautical pilot books
- ✓ Compass
- ✓ Hand compass
- ✓ VHF
- ✓ Log instruments
- ✓ Anemometer
- ✓ Windex
- ✓ Automatic pilot
- ✓ Binocular
- ✓ Clock & Barometer
- ✓ Flag set

ENGINE:

- ✓ Consumpt.–appr.2*4 l/h
- ✓ Diesel jerry can 20 lt.full
- ✓ Funnel
- ✓ Spare V-Belt
- ✓ Spare impeller
- ✓ Spare engine oil
- ✓ Motor battery

ELECTRIC:

- ✓ Main circuit breaker
- ✓ Service batteries x 3
- ✓ 220 V Breaker / Fuses
- ✓ Battery charger 220 V
- ✓ Shore power cable
- ✓ Spare fuses
- ✓ Sockets 12 / 220 V
- ✓ Elctr. Repair set

MOORING:

- ✓ Windlass
- ✓ Anchor with 100 m chain (10mm)
- ✓ Spare anchor
- ✓ Mooring lines x 4
- ✓ 2x15 m. & 2x30 m.
- ✓ Shore line 1x40 m.
- ✓ Fenders x 8
- ✓ Baloon fender x 2
- ✓ Gangway

SAFETY EQP. :

- ✓ Liferaft
- ✓ Danbuoy
- ✓ Life-Jackets
- ✓ Life-belts
- ✓ Manual bilge pump
- ✓ Automatic bilge pump
- ✓ Distress signals
- ✓ Torch + batteries
- ✓ Search light
- ✓ Radar reflector
- ✓ Anchor ball
- ✓ Wire cutter
- ✓ First aid kit
- ✓ Fire extinguishers
- ✓ Fire blanket
- ✓ Tool box
- ✓ Emergency tiller
- ✓ Lifebuoy light
- ✓ Dinghy repair kit
- ✓ Sail repair kit

COMFORT:

- ✓ Bimini-Top
- ✓ Sun awning
- ✓ Cockpit-Cushions
- ✓ Safety net (upon request)
- ✓ Life jackets (kids)
- ✓ Winch handles x 2
- ✓ Cockpit table
- ✓ Cockpit light
- ✓ Oars & pump for dinghy
- ✓ Waterhose with adaptor
- ✓ Water can
- ✓ Fuel jerry can – full
- ✓ Teak cockpit
- ✓ Swimming ladder
- ✓ Cockpit shower
- ✓ Boat-hook
- ✓ Bucket, Brush,Bailer
- ✓ Mask & Snorkel (1 set)
- ✓ Gas bottles x 2
- ✓ Hotwater boiler
- ✓ F. water pres. pump
- ✓ Holding tanks x 5
- ✓ Gas cooker + Oven
- ✓ Fridge 12 V
- ✓ Sink
- ✓ Galley equipment
- ✓ Coffee filter
- ✓ Sponge,tea-towels
- ✓ Dish washing liquid
- ✓ Pegs
- ✓ Blankets, Pillows
- ✓ Welcome packet

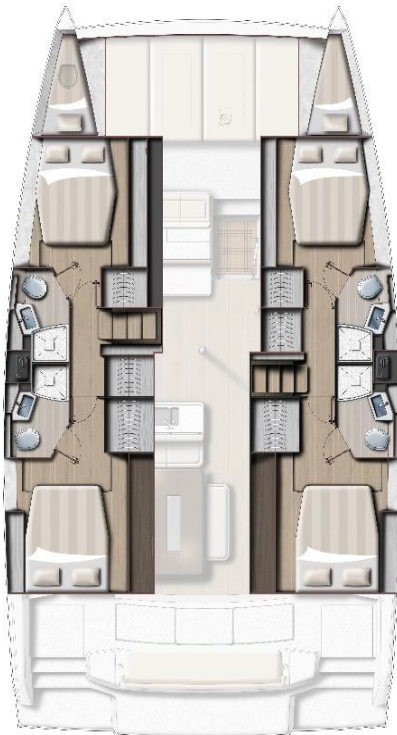

BASE : German, English, Turkish spoken, 24 hrs technical support, SMS-Info, SMS-Weather broadcast, beforehand provisioning (upon request), reception, restaurant, bar, shower & WC..

GÖCEK : Clinic - Ambulance, banks, markets, shops, food & veg market, laundry, car park, petrol station, rent a car, restaurants, bars and pubs...